

WIENERSTRASSE 9, A-7082 DONNERSKIRCHEN
 ÜBERSICHTSPLAN
 HAUS 0.4
 TOP 0.1 - ERDGESCHOSS

LAYOUT
 HOUSE 0.4
 APARTMENT 0.1 - GROUND FLOOR

BARRIEREFREI
 BARRIER - FREE

ZUGANG / ENTRANCE
 HAUS 0.4 / HOUSE 0.4
 TOP 0.1 / APARTMENT 0.1

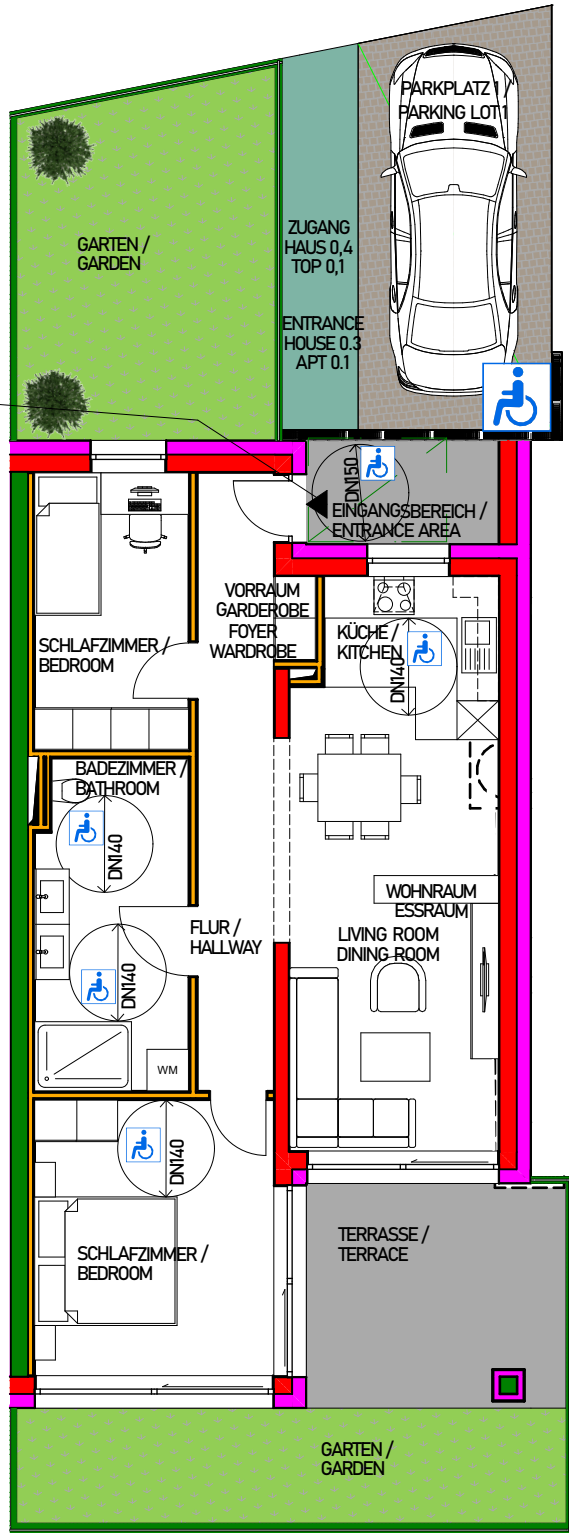

HOUSE 0.4 -
 APARTMENT 0.1
 ca. 68 m²
 GARDEN
 ca. 37 m²
 TERRASSE
 ca. 16 m²
 ENTRANCE
 ca. 6 m²
 PARKING LOT 1
 ca. 17 m²
 PARKING LOT 2
 ca. 14 m²

HAUS 0.4 - TOP 0.1
 ca. 68 m²
 GARTEN
 ca. 37 m²
 TERRASSE
 ca. 16 m²
 ZUGANG
 ca. 6 m²
 PARKPLATZ 1
 ca. 17 m²
 PARKPLATZ 2
 ca. 14 m²



Terra Atlas

IMMOBILIEN GMBH